

ReSound



SuperTune™  
Charger

**pulse™**  
ReSound

Congratulations on the purchase of your new fully-digital ReSound hearing instrument!

ReSound's state-of-the-art technology and the customized set-up selected by your hearing care professional will bring outstanding sound quality to your family, social and professional life.

Your ReSound Pulse hearing instrument has been adjusted to your individual hearing loss. Please familiarize yourself with the information in this booklet. Proper understanding and use of your new ReSound hearing instrument will allow you to derive maximum hearing benefit.

ReSound Pulse™ is a registered trademark of ReSound.

## Contents

	page
The charger for your ReSound Pulse Hearing Instrument . . . . .	4
Installation . . . . .	5
Recharge your ReSound Pulse Hearing Instrument . . . .	5-7
Indication Lights . . . . .	8-9
Compartment for Extra Batteries . . . . .	10-11
Maintenance . . . . .	14
Technical Data & Notifications . . . . .	14
Troubleshooting Guide . . . . .	16-19
Key Word Index . . . . .	21

## The Charger for your ReSound Pulse Hearing Instruments

1. Pockets
2. Indication lights
3. Compartment for extra batteries
4. Cable
5. Keyring container

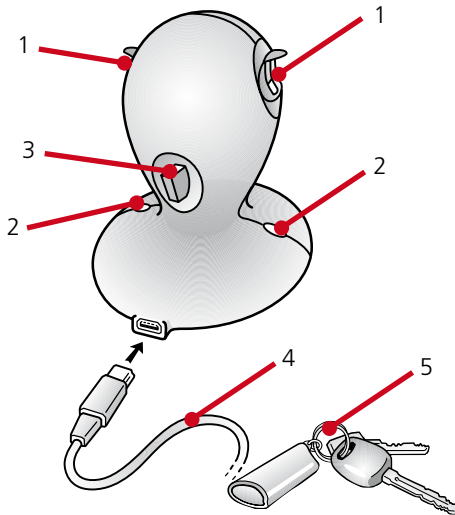

## Installation

Connect the cord of the separate adapter (power supply) to the charger unit and then connect the adapter to an ordinary wall power outlet.

You can also connect the charger with a standard USB cable (not included in delivery) to any PC and charge your ReSound Pulse devices.

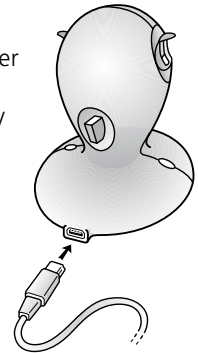

## Recharge your ReSound Pulse Hearing Instrument

The charger can recharge batteries placed in the ReSound Pulse hearing instrument. The charger has two pockets for hearing instruments. Both pockets can be used for either left or right side hearing instruments.

The battery charger will open the battery door automatically. Position the hearing instrument with the tube dome pointing downwards.

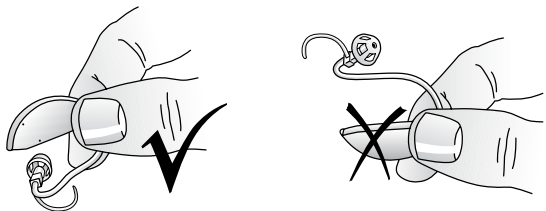

The hearing instrument is inserted in the charger by gently pushing the hearing instrument, battery door first, downwards in a bow movement (see drawings below) until it meets a natural stop. Make sure that the battery door of the hearing instrument is closed before inserting it in the charger.

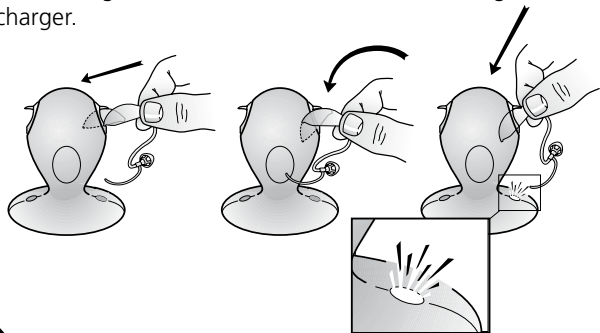

When the charger is connected to a power outlet via the adapter and one or two hearing instruments are inserted correctly, the corresponding green lamps (light emitting diodes) in the charger will light up.

When the charging has finished the light goes out.

The ReSound Pulse hearing instrument is removed from the charger by grasping and pulling on the instrument casing. It is not advisable to pull the hearing instrument out by the tube, as the function of the hearing instrument may be affected by damage to the tube. The hearing instrument is turned on as always by closing the battery door.

## Indication Lights

To ensure that both hearing instruments are charging correctly, there is an indicator light for each side.

### 1) **Steady light: during charging the light shines steadily.**

When the green light remains steadily on, charging is progressing. A full charge will take about 5 hours, which makes overnight charging most convenient. When the charging is completed, the green light will go out. The battery in the hearing instrument is now ready for use. If wanted, the hearing instrument can be left in the charger indefinitely and will be ready for use when it is taken out.

### 2) **Flashing light: indicates a problem with the battery**

If the indication light flashes, take out the hearing instrument and ensure that there is a rechargeable battery in. If the indication light continues to flash after reinserting the rechargeable battery may be broken, please exchange with a new one.

Please note that the charger is only compatible with the rechargeable Nickel Metal Hydride batteries you purchased with the charger or as replacement batteries. Only use ReSound branded rechargeable batteries to ensure the best performance of your ReSound Pulse.

### 3) **No light after inserting the hearing instrument**

Please ensure that the adaptor is connected to the mains and a rechargeable battery is in the hearing instrument. If the green light still does not light up after reinserting the hearing instrument, the battery door on the hearing instrument may not have opened sufficiently to allow charging. Remove the hearing instrument, close the battery door if open and reinsert the hearing instrument in the charger.

Please also see troubleshooting guide on page 16-19

## Compartment for Extra Batteries

One or two extra rechargeable batteries can be placed in the compartment in the center of the charger. Batteries are placed in the retractable insert.

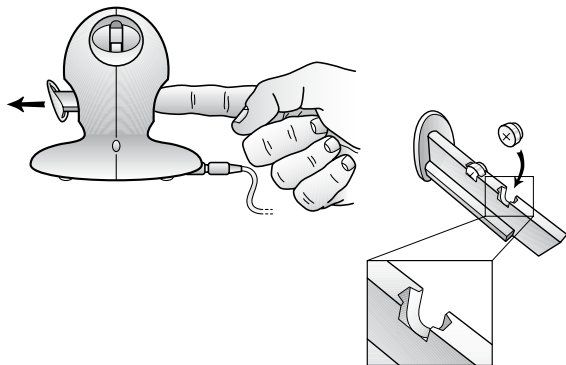

When the insert is slid into the charger the rechargeable batteries will be charged. If the batteries are fully discharged, it will take approximately 10 hours for them to fully recharge. Partially recharged batteries will provide shorter use time of the hearing instrument. Batteries which have been charged in the insert will remain charged for as long as they are left in the powered charger and can be kept there indefinitely without risk of damage.

Please use the key ring compartment to carry the whole insert with charged batteries with you. The fully charged batteries will retain the charge for months.

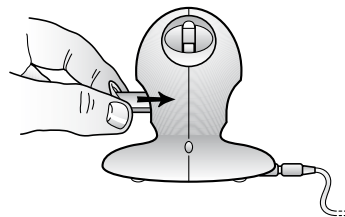
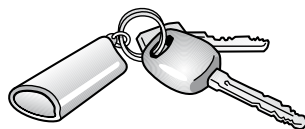

## Do NOT recharge Zinc Air batteries

Ordinary batteries for hearing instruments (Zinc Air batteries) can NOT be recharged! If an attempt is made to recharge a Zinc Air battery, the corresponding green lamp will flash shortly after insertion and the charging will not begin. The period until the green lamp starts flashing depends on the current of the Zinc Air battery inserted. If Zinc Air batteries are inserted in the compartment for extra batteries no specific signal is given, but no charging will occur.

If the battery type is rechargeable and an indication light is flashing, the error must be reported to ReSound or the dispenser or dealer where you bought the charger.

## Only use the charger indoors in a dry environment

The battery charger is designed for use in dry surroundings indoors, i.e. do not use the charger in bathrooms, etc. The battery charger will charge batteries when it is placed in an environment temperature between 0 °C and 40 °C (32 F and 104 F). Do not place the charger in direct sunlight, as the temperature can rise above 40 °C (104 F). At temperatures below 0 °C (32 F) or above 40 °C (104 F) the charger will not recharge hearing instrument batteries and hence the green lamps will not be lit. When the temperature returns to the operating range, the charger automatically begins to charge the connected batteries.

## Use the proper mains adapter (power supply)

The battery charger must only be powered by the included adapter (power supply) included in the delivery. To operate the battery charger in countries where your adapter plug doesn't fit the power outlets, it will normally be enough to use a plug adapter. The adapter can operate from a wide range of mains voltages, 100 – 240 Vac. Check the voltage before connecting!

You can also connect the charger with a standard USB cable (not included in delivery) to any PC and charge your ReSound Pulse instruments.

## Maintenance

Your ReSound Pulse battery charger can be cleaned on the outside by wiping it with a moist cloth. If necessary, use a small amount of mild detergent on the cloth.

## Technical data and notifications

### Input

(to mains adapter): 100-240 Vac / 50-60 Hz / 80 mA

Charging current: Max. 25 mA

Charging voltage: Max. 1.7 V

Charging time: Hearing instrument pockets: Approx.  
5 hours (discharged battery)  
Compartment for extra batteries:  
Approx. 10 hours (discharged battery)

## Repairs

If your SuperTune charger malfunctions, it must be repaired by a qualified technician. Do not attempt to open the case of the charger since this would invalidate the warranty.

If your SuperTune charger requires service, please contact your hearing care professional for assistance.



## Troubleshooting Guide

### SYMPTOM

### CAUSE

- Difficult insertion
- Difficult to insert the hearing instrument into the charger

Doesn't charge  
– no indication light

- Not inserted properly
- Not connected to the mains
- Battery compartment not open
- No battery in the device

– indication light flashing

- Zinc Air battery in the device
- Too quick re-insertion
- Rechargeable battery exceedingly drained or not used for long time
- Rechargeable battery broken down

### POSSIBLE REMEDY

- If the instrument does not insert easily, do not force it into the charger. Instead, remove the instrument and try again.
- Gently push the hearing instrument, battery door first, inward and downward in a bow movement until it meets a natural stop. The instrument should insert with just a slight amount of pressure.

- Ensure proper insertion of the hearing instrument in the charger (NOTE: The hearing instrument is not fully inserted until the tab on the rubber grommet is even with the end of the hearing instrument and within 1 mm of the tubing)
- Ensure that the rubber grommet is tightly inserted

- Connect the charger with the adapter to the mains
- Take the device out of the charger, close the battery door if open and reinsert.
- Insert rechargeable battery

- Replace it with a rechargeable battery
- Remove the hearing instrument from the charger, wait 5 seconds and then reinsert the device
- Re-insert the hearing instrument a couple of times until steady indication light
- Replace with new rechargeable battery

## Troubleshooting Guide

### SYMPTOM

### CAUSE

– no charge in batteries in keyring compartment

- Compartment not inserted properly
- Batteries not placed correctly in compartment
- Keyring compartment not inserted in charger for some time

Short battery life

- Hearing instrument not inserted properly
- Battery worn out

If there are any other problems not mentioned in this guide, please contact your hearing care professional.

### POSSIBLE REMEDY

- Ensure that the compartment slid is properly inserted into the charger
- Ensure that batteries are placed correctly in the retractable insert
- Insert the compartment slid into the charger to charge the batteries

- Ensure proper insertion of the hearing instrument in the charger
- Replace with a new rechargeable battery (NOTE: A rechargeable battery can be charged and discharged many hundred times. However, it will eventually wear out - this is not a defect and corresponds to normal wear and tear. When the use time is noticeably shorter, it is time to replace your battery)

## Key Word Index

Extra charged batteries . . . . .	10-11
Indication lights on the charger . . . . .	8-9
Installation of the charger . . . . .	5
Maintenance of the charger. . . . .	14
Recharge your ReSound Pulse hearing instrument . . . .	5-7
Troubleshooting guide. . . . .	16-19



Please ask your local hearing care professional concerning disposal of your charger

**Worldwide headquarters**

GN ReSound A/S  
Lautrupbjerg 9 • P.O. Box 130  
DK-2750 Ballerup, Denmark  
Tel.: +45 45 75 11 11  
Fax: +45 45 75 11 19  
[www.gnresound-group.com](http://www.gnresound-group.com)

**Australia**

GN ReSound Pty. Ltd.  
Unit R1 Regent Park Estate  
391 Park Road  
Regent Park NXW 2143  
Tel.: 02 9743 9707  
Fax: 02 9743 7472  
[www.gnresound.com.au](http://www.gnresound.com.au)

**United Kingdom**

GN ReSound Ltd.  
1 Landscape Close  
Weston Business Park  
Weston-on-the-Green  
Oxon OX25 3SX  
Tel.: 0 1869 343 500  
Fax: 0 1869 343 466  
[www.gnresound.co.uk](http://www.gnresound.co.uk)

**New Zealand**

GN ReSound (NZ) Ltd.  
12 Parkway Drive  
Mairangi Bay  
Auckland  
Tel.: (free) 0800 900 126  
Fax: (free) 0800 007 695  
[www.gnresound.co.nz](http://www.gnresound.co.nz)



Any issues relating to the EU Medical Device Directive 93/42/EEC should be directed to GN ReSound A/S.

**pulse**<sup>TM</sup>  
ReSound

[www.resoundpulse.com](http://www.resoundpulse.com)